

CHAINS

RE-ESTABLISHED CORNERS FOR OREGON STATE BOARD OF FORESTRY
(See official plat)
One Quarter corner common to Sections 16 and 17, T3S,
R8W, W.M., Tillamook County, Oregon.

ORIGINAL

No evidence of original corner found.

RE-ESTABLISHED

Var. 21 1/2 E

Set 1 1/2" x 36" galvanized iron pipe with 3" bronze cap marked "OREGON STATE
BOARD OF FORESTRY 1/4 S17 S16 1961 RS401", 32 inches in ground, and
from which a:

- 7" Fir bears N34 1/2 E 16.9 ft.; scribed 1/4 S16 BT.
- 4 1/2" Fir bears S85 W 24 1/2 ft.; scribed 1/4 S17 BT.

Set 4" x 4" x 52" white painted Cedar post 1.0 ft. E. of corner pipe.
Oregon State Board of Forestry metal location poster on 7" Fir BT.

One Quarter corner common to Sections 15 and 16, T3S,
R8W, W.M., Tillamook County, Oregon.

ORIGINAL

No evidence of original corner found.

RE-ESTABLISHED

Set 1 1/2" x 36" galvanized iron pipe with 3" bronze cap marked "OREGON STATE
BOARD OF FORESTRY 1/4 S16 S15 1961 RS401", 34 inches in ground, in
mound of rock, and from which a:

- 8" Fir bears N56 1/2 E 52.1 ft.; scribed 1/4 S15 BT.
- 12" Fir bears N73 W 77.5 ft.; scribed 1/4 S16 BT RS401.

Set 4" x 4" x 54" white painted Cedar post 1.0 ft. N.E. of corner pipe.
Oregon State Board of Forestry metal location poster on 8" Fir BT.

Dated July 12, 1961

Re-established by

Present and witnessed by G. Nylund
A. Duncan
D. Spiesschaert



Richard A. Morris
MAY 10, 1957
Richard A. Morris
401

see later survey

VOID

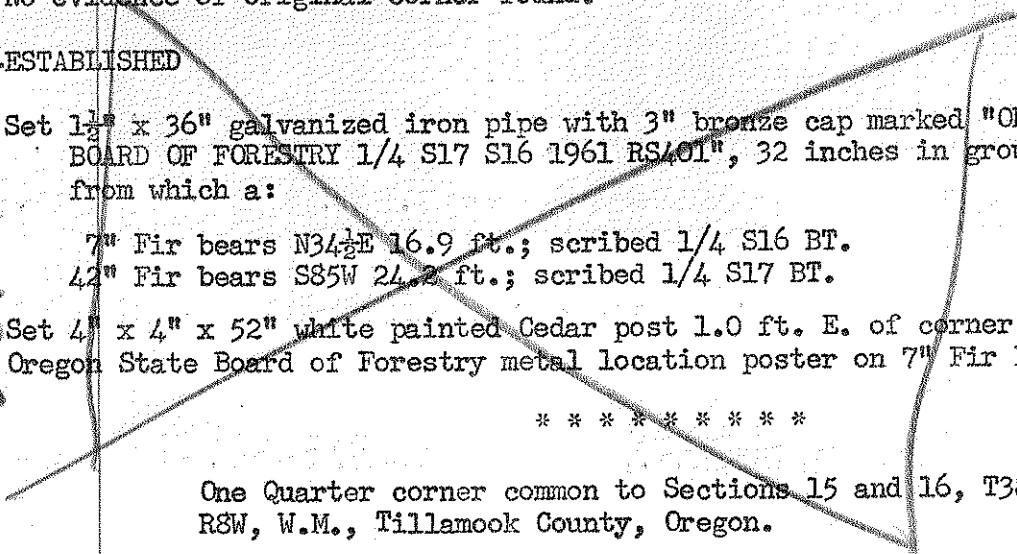

515